



### 用途

该类固定式定值分流器用于扩大仪表测量范围，其额定电流见相应表格，

### Application

The interchangeable shunts are used to multiply the measuring range of current of measuring instruments.

### 主要技术参数

准确度等级：

2~4000A: 0.5级; 5000~10000A: I级

环境条件：

-40~+60°，相对湿度≤95(35°C)

耐机械力性能：

能承受加速度为70米/秒<sup>2</sup>及冲击频率每分钟80~120次6小时的运输颠簸。

过负载性能：

120% 额定电流值，2小时。

电压降：50mV, 60mV, 75mV, 100mV。

负载下发热：

温升变化趋于稳定后，额定电流50A以下不超过80°C。

额定电流50A以上不超过120°C。

### Basic specifications

Accuracy class: 0.5 for 2~4000A; 1 for 5000~10000A

Ambient conditions: Temperature: -40~+60°C

relative humidity: ≤95%(at 35°C)

Capacity withstand mechanical force:

It is capable of withstanding the transport bumping at acceleration of 70/s<sup>2</sup> and shock frequency of 80~120 times/mi for hr.

overrating capacity: 120% of rated current for 2hr.

Voltage drop: 75mV, 50mV, 60mV, 100mV.

Giving out heat when loaded: not be more than 80°C

after temperature rise gets steady: not be more than 120°C at rated current of over 50A.

特殊要求在订货时提出

## 外形尺寸 Dimensions(mm)

额定电流 (A)	a	c	b	C1	C2	H	S	d	d1	d2	电流端螺钉	电位端螺钉					
											(mm)一只	(mm)一只					
5、10、15、 20、30、50	120	100	20			15	5	30	42	60	M5×6-2	M4×6-2					
75、100	104	85	22								M8×35-2						
150、200	116																10
250、300	126	100	26			22	6			49	64	M10×35-2					
400			38														
500			45														
600			62														
750			76														
1000			95										50				
1500、2000	190	160	110			100	13			84	M12×60-4	M5×6-2					
2500			145														
3000			195										2-50	55			
4000			210											80			
5000	284	220	320			150	18			88	M16×80-8						
6000			2-60														
7500	290		400								M16×80-12						
10000			3-50										2-90				

## ■ 构造图 Construction(mm)

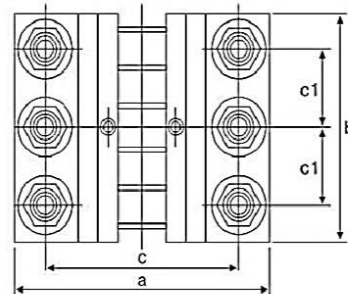
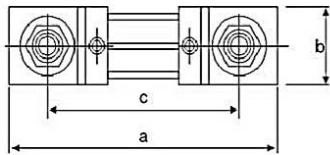
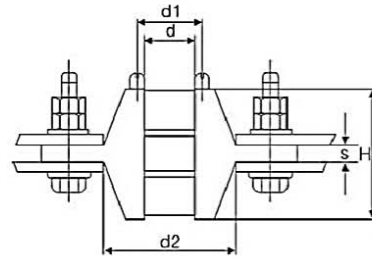
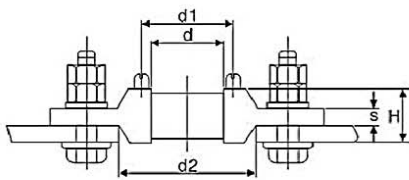
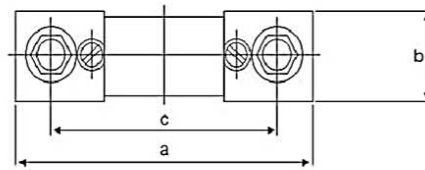
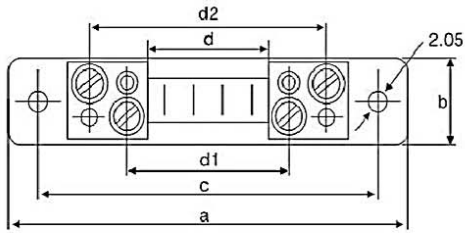
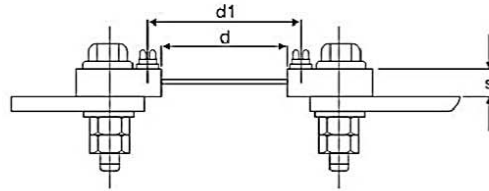
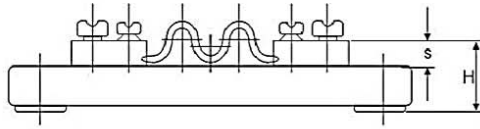

1500~3000A

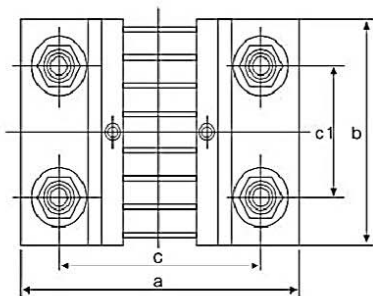
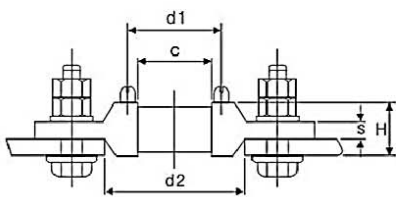

750~1000A

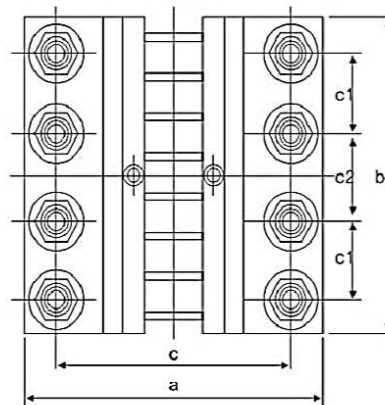

4000~10000A